







## 16 The Twenties, Cirencester, Gloucestershire.

### DIRECTIONS

Please use the postcode GL7 6ES or call the office at any time for detailed directions from your location.

### SUMMARY

A well presented terraced house located within this popular village comprising open plan kitchen/living area, bathroom and large master bedroom. The property further benefits from driveway parking and a large rear garden.

### PROPERTY

The ground floor accommodation is accessed via a useful entrance porch and leads through to the open plan living/ kitchen area with stairs rising to the first floor. The kitchen is fitted with a range of cupboards and drawers, Belfast sink, and white goods. To the first floor is the large master bedroom which features dual aspect windows and allows an abundance of natural light. The modern bathroom comprises bath with shower over, wc and wash hand basin.

### GARDEN

To the front of the property is a driveway providing parking for one vehicle. The pretty rear garden is full enclosed by timber fencing and has been designed with low maintenance in mind. There is an area of decking adjoining the property with a gravel and patio area to the rear.

### LOCATION

The property is located in the thriving village of Siddington, just one mile south of the historic market town of Cirencester. There is easy access to the village post office and shop while Cirencester offers a wide range of amenities and provides easy access to the nearby road and rail network.

### VIEWING

Viewing is available by appointment 7 days a week. Please call your local office to arrange.

### FEES

Please see the full online listing, our website, or ask a colleague for a full list of any fees which may be payable in relation to this tenancy.

### AGENTS NOTE

We wish to inform prospective purchasers that we have prepared these sales particulars as a general guide. We have not carried out a survey, nor have we tested any services, appliances or any specific fittings at the property. Room sizes should not be relied upon for carpets and furnishings.

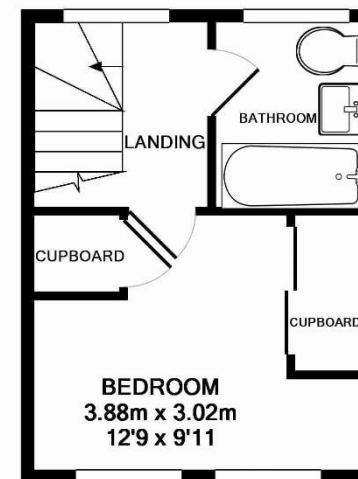

1ST FLOOR

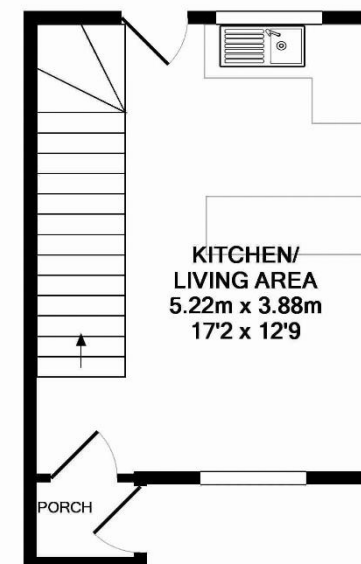

GROUND FLOOR

Measurements are approximate. Not to scale. Illustrative purposes only  
Made with Metropix ©2011